

## Lean and undemanding

- Minimum space requirement
- Quick to install
- Impeller or propeller
- Firm 'O' ring seating
- Different inlet geometries
- Tandem mechanical seal with oil chamber seal leakage detection by float switch
- Direct driven by three phase motor with thermal protection
- Bearing temperature probes
- Capacities up to 7,000 l/s (111,000 gpm)
- Heads up to 50 m (164 feet)

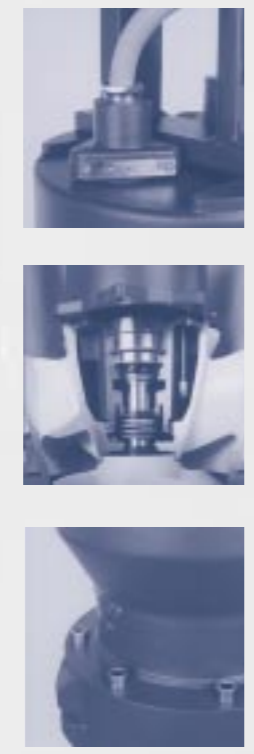

## KSB provides worldwide:



**24 hr service**  
The assembly, inspection, maintenance and repairs we provide set the standard.



**Advice at site**  
KSB is active globally. A network of manufacturing plants and sales offices world-wide provide the fast and comprehensive service our customers expect.



**Competence and experience**  
KSB has supplied pumps for over a century. This 125 year tradition is a 125 years of experience allied to the latest technology.



3D Marketing + Design, Halle  
Subject to technical modifications  
02/01  
1579.02/2-10

## AN EFFECTIVE SOLUTION – EVEN IN A TIGHT SITUATION



**There's more to Amacan than meets the eye.**

At first glance you may think there's nothing much to see. The Amacan pump does its work so quietly and efficiently – totally hidden from enquiring eyes. Look closer and you will see that the Amacan can fit in to a fraction of the space required by conventional submersible pumps. It can be installed inside the smallest of discharge tubes – an indispensable factor when upgrading existing systems where a slim pump is required.



The performance is also impressive - providing up to two thirds more flow compared to conventional propeller pumps of similar dimensions.

A unique pump that is also versatile as can be seen from the following list of applications that Amacan has handled successfully

- Storm water-pumping stations
- Sewage treatment plants
- Land drainage
- Surface water drainage
- Aquaculture
- Cooling water supply
- Water pollution and flood control
- Pumping screened sewage



**A Versatile Professional**

Different liquids demand different impeller designs. Amacan P is fitted with an axial flow propeller of Ever Clean Blade (ECB) design for handling clean and contaminated water. Amacan S with a mixed flow impeller is ideally suited for pumping raw and contaminated water to higher heads.

The impeller of the Amacan P and Amacan S can be offered selectively in aluminium multi-alloy bronze or duplex steel.

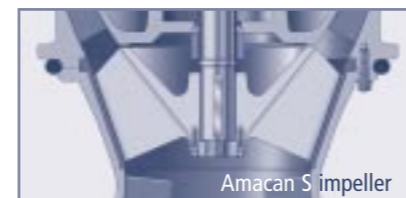

**ECB-Prop**

**Protection against Fibers**

The mechanical seal chamber is protected by a labyrinth

**Flexible and adaptable installations.**

Amacan pumps are not limited to one type of installation. They fit many types of discharge pipe, both steel and concrete. Also various types of outlet structures e.g. open and closed intake chambers for low water levels, overflows weirs and discharges into pipes installed both above and below floor level.

**Robust and adaptable**

Tolerates extreme external temperatures due to the optimum motor cooling by the pumped liquid. Thermal protection and bearing temperature probes as standard.



**Everything's straight forward**

A simple 'O' ring ensures the pump sits true and secure.

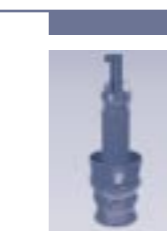

**Favourable inlet conditions**

Vortex free inflow and vibration free due to the bellmouth design.

Amacan P

Installation

